

NOTES TO USERS

This map is for use in administering the National Flood Insurance Program. It does not necessarily identify all areas subject to flooding, particularly from local drainage sources of small size. The **community map repository** should be consulted for possible updated or additional flood hazard information.

To obtain more detailed information in areas where **Base Flood Elevations (BFEs)** and/or **floodways** have been determined, users are encouraged to consult the Flood Profiles and Floodway Data and/or Summary of Stillwater Elevations tables contained within the Flood Insurance Study (FIS) report that accompanies this FIRM. Users should be aware that BFEs shown on the FIRM represent rounded whole-foot elevations. These BFEs are intended for flood insurance rating purposes only and should not be used as the sole source of flood elevation information. Accordingly, flood elevation data presented in the FIS report should be utilized in conjunction with the FIRM for purposes of construction and/or floodplain management.

Boundaries of the **floodways** were computed at cross sections and interpolated between cross sections. The floodways were based on hydraulic considerations with regard to requirements of the National Flood Insurance Program. Floodway widths and other pertinent floodway data are provided in the Flood Insurance Study report for this jurisdiction.

Certain areas not in Special Flood Hazard Areas may be protected by **flood control structures**. Refer to Section 2.4 "Flood Protection Measures" of the Flood Insurance Study report for information on flood control structures for this jurisdiction.

The **projection** used in the preparation of this map was Universal Transverse Mercator (UTM) zone 13. The **horizontal datum** was NAD 83, GRS80 spheroid. Differences in datum, spheroid, projection or UTM zones used in the production of FIRMs for adjacent jurisdictions may result in slight positional differences in map features across jurisdiction boundaries. These differences do not affect the accuracy of this FIRM.

Flood elevations on this map are referenced to the North American Vertical Datum of 1988 (NAVD 88). These flood elevations must be compared to structure and ground elevations referenced to the same **vertical datum**. An average offset between NAVD 88 and the National Geodetic Vertical Datum of 1929 (NGVD 29) has been computed for each Laramie County flooding source. This offset was then applied to the NGVD 29 flood elevations that were not revised during the creation of this countywide format FIRM. The offsets for each flooding source shown on this firm are shown in the Laramie County Vertical Datum Offset Table below. For information regarding conversion between the National Geodetic Vertical Datum of 1929 and the North American Vertical Datum of 1988, visit the National Geodetic Survey Website at <http://www.ngs.noaa.gov> or contact the National Geodetic Survey at the following address:

NGS Information Services, NOAA, NNGS12
National Geodetic Survey SSMC-2, #9202
1315 East-West Highway
Silver Spring, MD 20910-3282

To obtain current elevation, description, and/or location information for **bench marks** shown on this map, please contact the Information Services Branch of the National Geodetic Survey at (301) 713-3242, or visit its website at <http://www.ngs.noaa.gov>

Base map information shown on this FIRM was provided by the Laramie County GIS Department and the City of Cheyenne GIS Department. These data are current as of 2004

This map reflects more detailed and up-to-date **stream channel configurations and floodplain delineations** than those shown on the previous FIRM for this jurisdiction. As a result, the Flood Profiles and Floodway Data tables in the Flood Insurance Study Report (which contains authoritative hydraulic data) may reflect stream channel distances that differ from what is shown on this map. Also, the road to floodplain relationships for unrevised streams may differ from what is shown on previous maps.

Corporate limits shown on this map are based on the best data available at the time of publication. Because changes due to annexations or de-annexations may have occurred after this map was published, map users should contact appropriate community officials to verify current corporate limit locations.

Please refer to the separately printed **Map Index** for an overview map of the county showing the layout of map panels; community map repository addresses; and a Listing of Communities table containing National Flood Insurance Program dates for each community as well as a listing of the panels on which each community is located.

Contact the **FEMA Map Service Center** at 1-800-358-9616 for information on available products associated with this FIRM. Available products may include previously issued Letters of Map Change, a Flood Insurance Study report, and/or digital versions of this map. The Map Service Center may also be reached by Fax at 1-800-358-9620 and its website at <http://www.msc.fema.gov>.

If you have **questions about this map** or questions concerning the National Flood Insurance Program in general, please call 1-877-FEMA Map (1-877-338-2627) or visit the FEMA website at <http://www.fema.gov>.

Laramie County Vertical Datum Offset Table

Flooding Source	Vertical Datum Offset (ft)
Allison Draw	3.33
Allison Draw Salt Flow Path	3.33
Clear Creek	3.33
Cow Creek	3.33
Dry Creek	3.33
South Fork Allison Draw	3.33
Western Hills Draw (North Fork Dry Creek)	3.33
Wyoming Hereford Ranch Reservoir No. 1 - Emergency Spillway	3.33

Example: To convert Clear Creek elevations to NAVD 88, 3.33 feet were added to the NGVD 29 elevations.

Panel Location Map

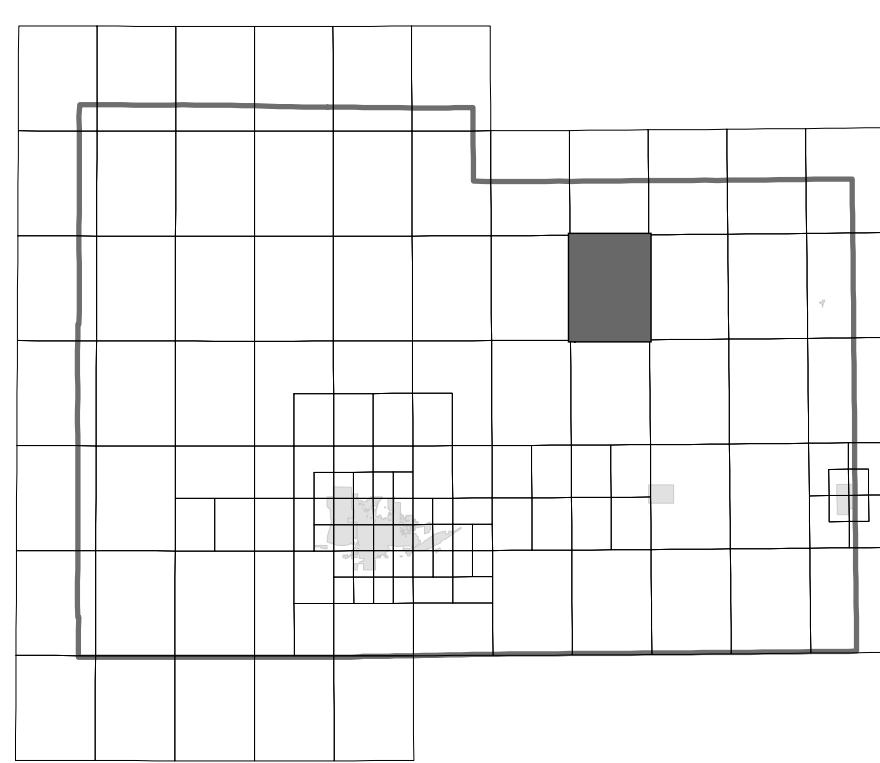

This digital Flood Insurance Rate Map (FIRM) was produced through a cooperative partnership between Laramie County, the City of Cheyenne, and the Federal Emergency Management Agency (FEMA). Laramie County and the City of Cheyenne have implemented a long-term approach of floodplain management to reduce the costs associated with flooding. As part of this effort, Laramie County has joined in a Cooperating Technical Partner agreement with FEMA to produce this digital FIRM. Additional flood hazard information and resources are available from local communities, Laramie County and the City of Cheyenne.

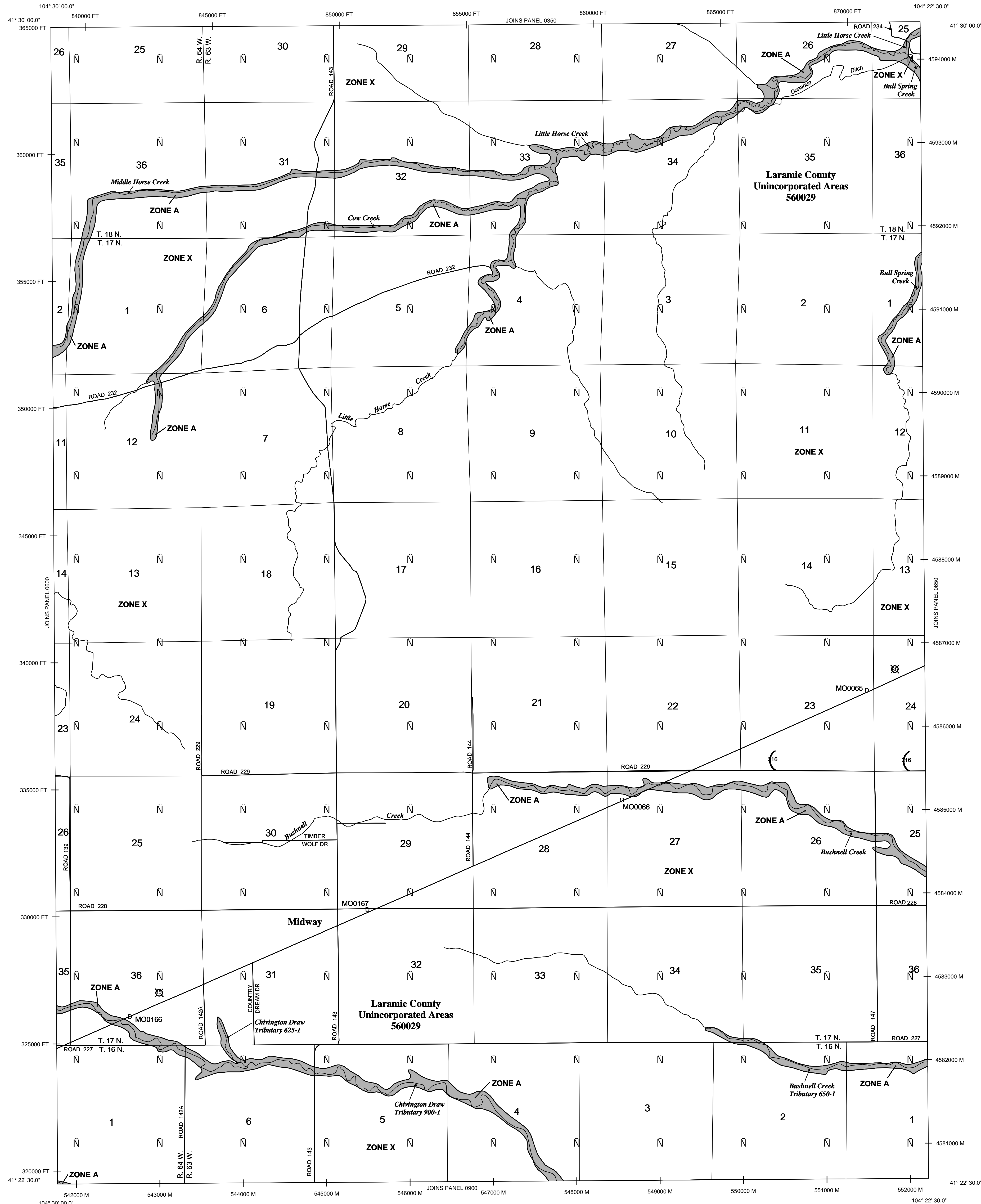
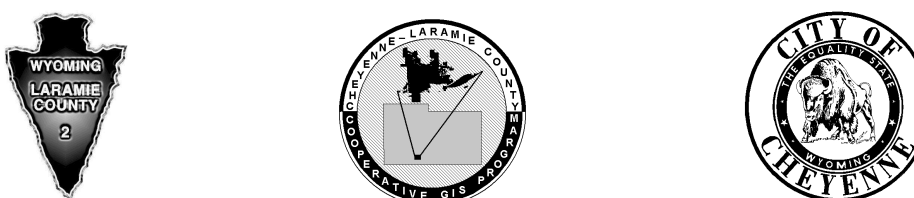

LEGEND

SPECIAL FLOOD HAZARD AREAS (SFHAs) SUBJECT TO INUNDATION BY THE 1% ANNUAL CHANCE FLOOD

The 1% annual chance flood (100-year flood), also known as the base flood, is the flood that has a 1% chance of being equaled or exceeded in any given year. The Special Flood Hazard Area is the area subject to flooding by the 1% annual chance flood. Areas of Special Flood Hazard include Zone A, AE, AH, AO, AR, A99, V, and VE. The Base Flood Elevation is the water-surface elevation of the 1% annual chance flood.

- ZONE A** No Base Flood Elevations determined.
- ZONE AE** Base Flood Elevations determined.
- ZONE AH** Flood depths of 1 to 3 feet (usually areas of ponding); Base Flood Elevations determined.
- ZONE AO** Flood depths of 1 to 3 feet (usually sheet flow on sloping terrain); average depths determined. For areas of alluvial fan flooding, velocities also determined.
- ZONE AR** Special Flood Hazard Areas formerly protected from the 1% annual chance flood by a flood control system that was subsequently identified. Zone AR indicates that the former flood control system is being restored to provide protection from the 1% annual chance or greater flood.
- ZONE A99** Area to be protected from 1% annual chance flood by a Federal flood protection system under construction; no Base Flood Elevations determined.

FLOODWAY AREAS IN ZONE AE
The floodway is the channel of a stream plus any adjacent floodplain areas that must be kept free of encroachment so that the 1% annual chance flood can be carried without substantial increases in flood heights.

OTHER FLOOD AREAS
ZONE X Areas of 0.2% annual chance flood; areas of 1% annual chance flood with average depths of less than 1 foot or with drainage areas less than 1 square mile; and areas protected by levees from 1% annual chance flood.

OTHER AREAS
ZONE X Areas determined to be outside the 0.2% annual chance floodplain.
ZONE D Areas in which flood hazards are undetermined, but possible.

- Floodplain boundary
- Floodway boundary
- Zone D boundary
- Boundary dividing Special Flood Hazard Area zones and boundary dividing Special Flood Hazard Areas of different Base Flood Elevations, flood depths or flood velocities.
- Base Flood Elevation line and value: elevation in feet*
- Base Flood Elevation value where uniform within zone: elevation in feet*
- *Referenced to the North American Vertical Datum of 1988
- A-A Cross section line

Geographic coordinates referenced to the North American Datum of 1983 (NAD 83), Western Hemisphere
1000-meter Universal Transverse Mercator grid ticks, zone 13
5000-foot ticks: Wyoming State Plane coordinate system, east zone (SPSZONE 4901), Lambert Conformal Conic projection
National Geodetic Survey bench mark (see explanation in Notes to Users section of this FIRM panel)

MAP REPOSITORY
Refer to listing of Map Repositories on Map Index

EFFECTIVE DATE OF COUNTYWIDE FLOOD INSURANCE RATE MAP
JANUARY 17, 2007

EFFECTIVE DATE(S) OF REVISION(S) TO THIS PANEL

For community map revision history prior to countywide mapping, refer to the Community Map History table located in the Flood Insurance Study report for this jurisdiction.

To determine if flood insurance is available in this community, contact your insurance agent or call the National Flood Insurance Program at 1-800-638-6620.

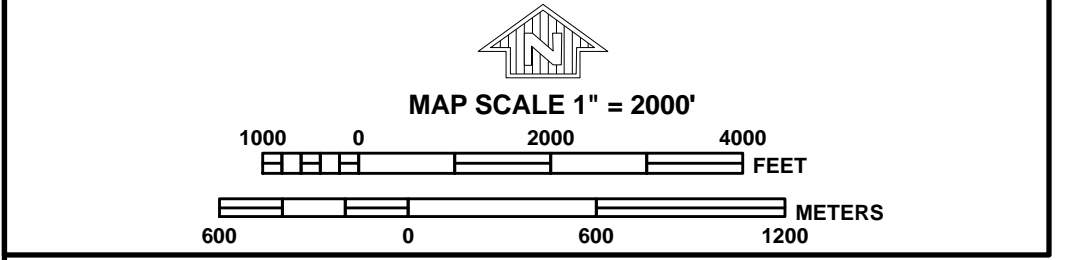

NFIP
NATIONAL FLOOD INSURANCE PROGRAM

PANEL 0625F

FIRM
FLOOD INSURANCE RATE MAP
LARAMIE COUNTY, WYOMING AND INCORPORATED AREAS

PANEL 625 OF 1650
(SEE MAP INDEX FOR FIRM PANEL LAYOUT)

CONTAINS	COMMUNITY	NUMBER	PANEL	SUFFIX
LARAMIE COUNTY	560029	0625	F	

Notice to User: The **Map Number** shown below should be used when placing map orders. The **Community Number** shown above should be used on insurance applications for the subject community.

MAP NUMBER
56021C0625F

EFFECTIVE DATE
JANUARY 17, 2007

Federal Emergency Management Agency